

# Design, Inclusion and Political Artifacts

Langdon Winner

Blog: <http://technopolis.blogspot.com>

Twitter: @langdonw

Email: winner@rpi.edu



Long Island Expressway, early 1940s



JEFF WILTSE



*A Social  
History of  
Swimming  
Pools in  
America*

CONTESTED  
WATERS







80:--FLEISHHACKER SWIMMING POOL. SAN FRANCISCO. CALIFORNIA.







Racial conflicts

Fairground Pool  
St. Louis, 1940s



Whites only

Cairo, Illinois, 1940s





The abandonment of public places:  
era of the backyard swimming pool





**Ed Roberts**

**(1939 – 1995)**



Rolling Quads --Ed Roberts with one  
of the revolutionary brothers,  
Berkeley, California – late 1960s





Ed Roberts



Martin Luther King

Two leaders of civil rights movements



Design for inclusion:

Cutaway curbs



Ramps for  
buildings



The Ed Roberts Campus

Berkeley, California



**Is there a right to shape technology?**





Francisco Guzmán Castillo

The theory of functional diversity

Dickensian story for our time:

## **A Tale of Two Media Centers**



# EMPAC: Experimental Media Performing Arts Center

Rensselaer Polytechnic Institute, Troy NY

# EMPAC interior







EMPAC: sonically isolated auditorium

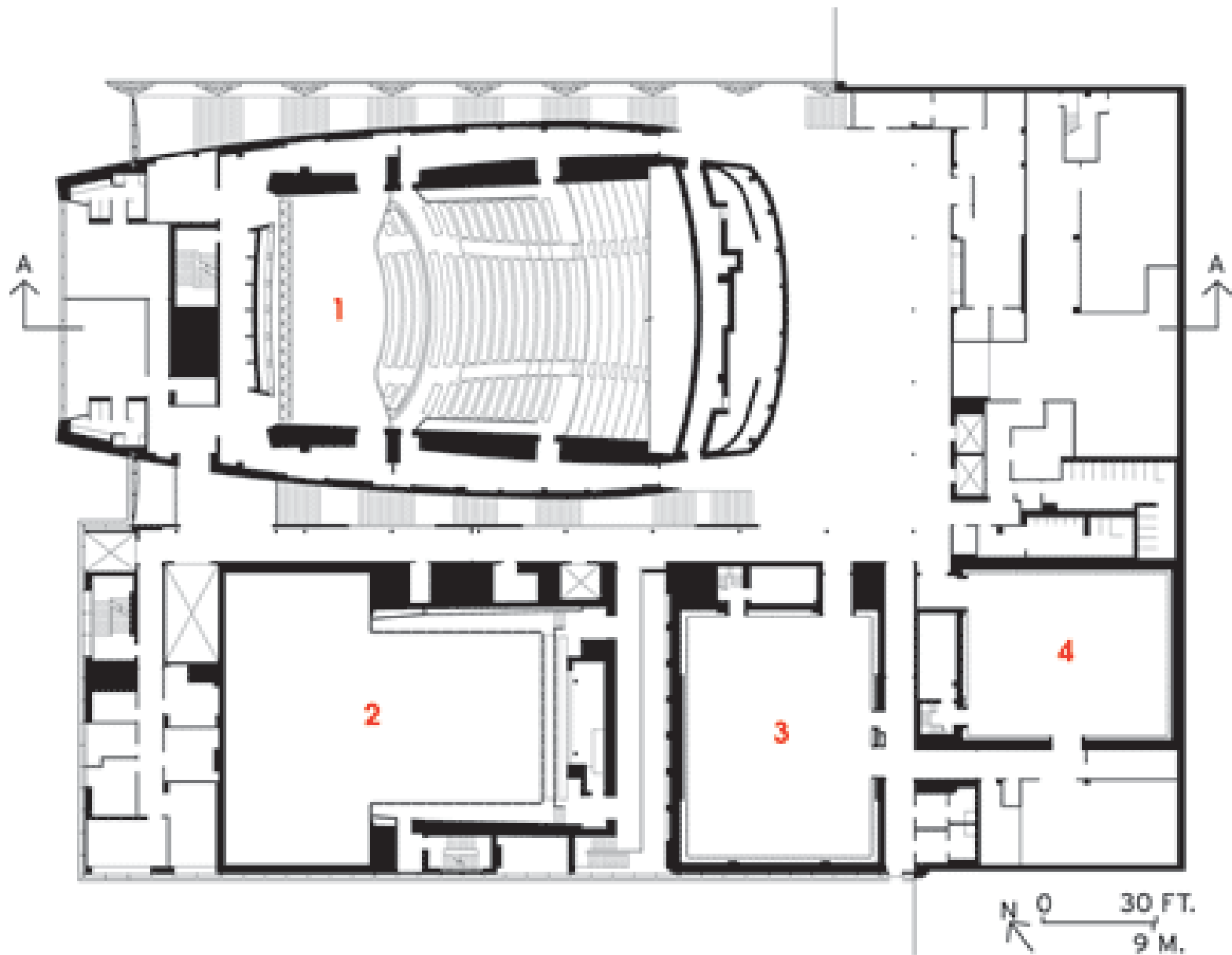

Very little usable space for creative work.

Some buildings make a statement, e.g.  
The Parthenon, The Vatican, etc.

Some buildings ask a question ...

Some buildings make a statement, e.g.  
The Parthenon, The Vatican, etc.

Some buildings ask a question ...

EMPAC's question seems to be:

Can you put a 16<sup>th</sup> century Spanish galleon  
in a 1950s American refrigerator?





YES, YOU CAN !!!







Founders: Steve Pierce and Branda Miller



The Sanctuary's performance space

## Media workshops for people in the community





